

Ø 3–5mm  
1/8"– 3/16"

4.8MM  
3/16"

Application 6:1

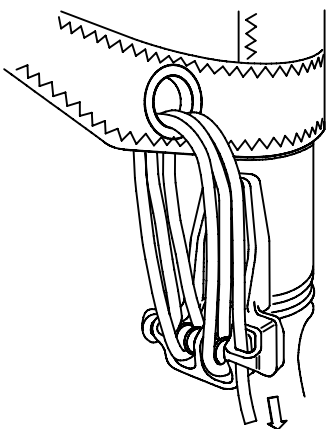

## Section 'AA'

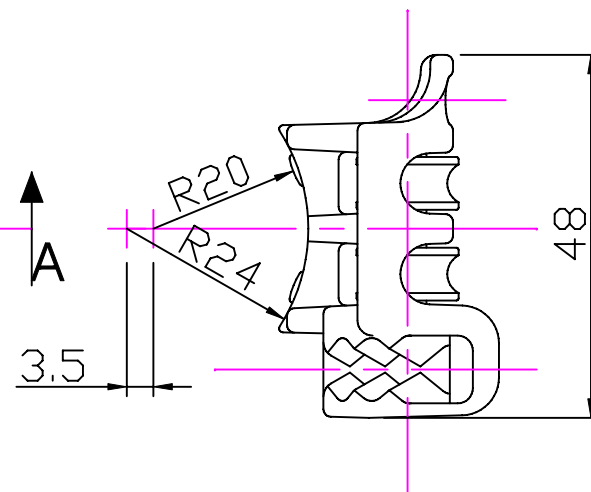
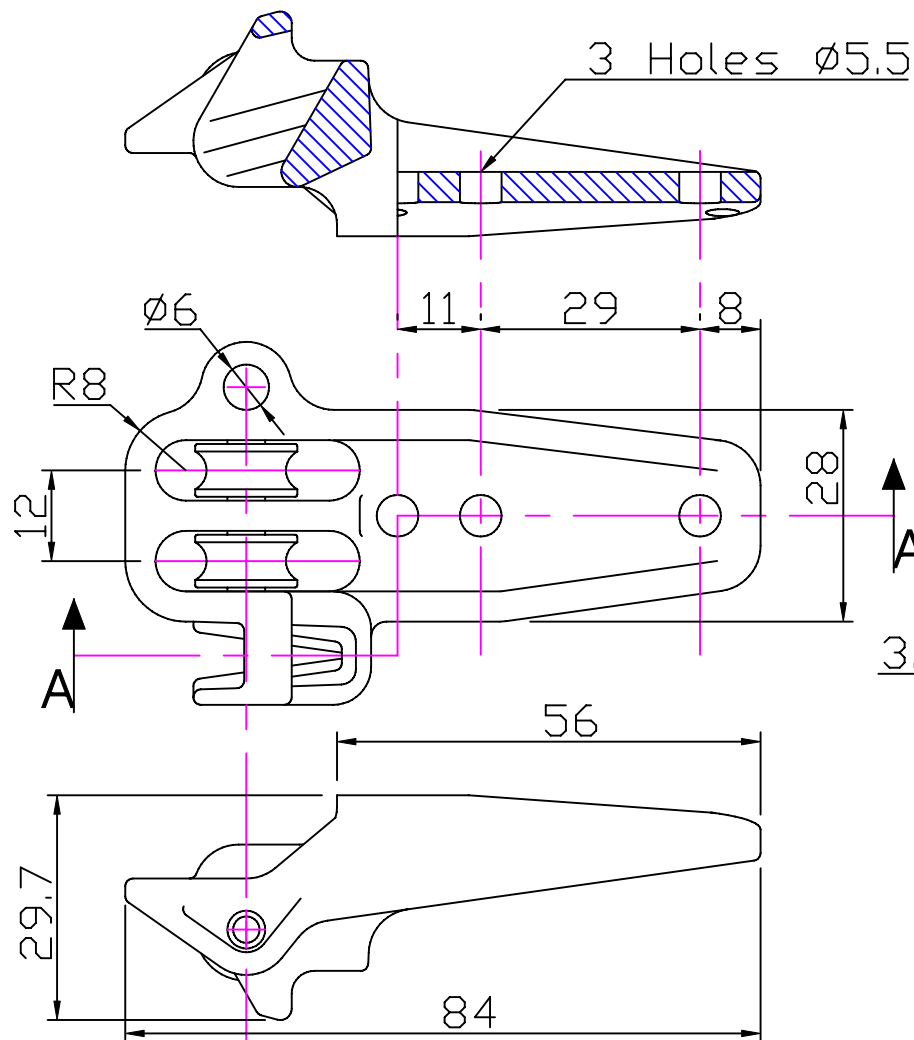

Notes: –  
For marine applications, use a silicone sealant or a bedding compound to avoid electrolytic action between the cleat and metal fastenings.

Issue: 2. May 2006  
ID250.dwg

Material:  
Cleat – Diecast Aluminium  
Roller – Reinforced Nylon

Installation Drawing for: –  
**CL250**  
The Gap Closer



Clamcleats Limited  
Watchmead  
Welwyn Garden City  
Hertfordshire AL7 1AP  
England

Telephone +44 (0)1707 330101  
Fax +44 (0)1707 321269  
<http://www.clamcleat-rope-cleats.com>



Scale 1:1  
All dimensions in mm.